

FLEET STREET PLANT PRESS

A NEW URBAN GARDEN FOR THE
FLEET STREET QUARTER

and project for

The London Festival of Architecture

WAYWARD
tom@wayward.co.uk
07817782431



3 *Pyrus Regale.*
The Pearce Royall.



5 *Pyrus Cydonium.*
The Quince Pearce.



4 *Pyrus Palatinum.*
The Burgomot Pearce.



6 *Pyrus Episcopatum.*
The Bishops Pearce.



7 *Pyrus superba, sive Katherina.*
The Katherine Pearce tree.



8 *Pyrus hyemalis.*
The Winter Pearce tree.



* The place.

The tame Pearre trees are planted in orchards, as be the apple trees. *Quorum varia in sitione ex agrestibus mites ac edules fructus redditi sunt.* All these before specified, and many sortes more, and those most rare and good, are growing in the ground of Master *Richard Pointser*, a most cunning and curious graffer and planter of all manner of rare fruites, dwelling in a small village neere London called *Twicknam*; and also in the ground of an excellent graffer and painfull planter, Master *Henry Banbury*, of *Touthill streete* neere vnto *Westminster*; and likewise in the ground of a diligent and most affectionate louer of plants Master *Warnar* neere *Horshey Downe* by London, and in diuers other grounds about London (but beware the Bag and Bottle) seeke elsewhere for good fruit faithfully deliuered.

* The time.

The flowers do for the most part come foorth in *Aprill*, the leaues afterwarde; all Peares are not ripe at one time; some be ripe in *Iuly*, others in *August*, and diuers in *September* or later.

* The names.

The tame or orchard Pearre tree is called in Greeke *ἀμρ*, or with a double *πρ ἀμρ*: in Latine *Pyrus urbana*, or *Cultiva*: of *Tarentinus* in his *Geoponikes* *ἀμρ*: in high Dutch *Bijrbaum*: in lowe Dutch *Peerboom*: in French *Porrier*.

The Pearre or fruit it selfe is called in Greeke *ἀμρ*: in Latine *Pyrus*: in high Dutch *Birn*: in lowe Dutch *Peere*: in Italian *Pere*: in French *Poyre*: in Spanish *Pera*: in English *Pearre*.

* The temperature and vertues.

Leauing the diuers and sundrie surnames of Peares, let vs come to the faculties which the A
Nann 1 phisicians

DESIGN REFERENCES

These early printers and prints are key design references in the project from key forms to tiny details.

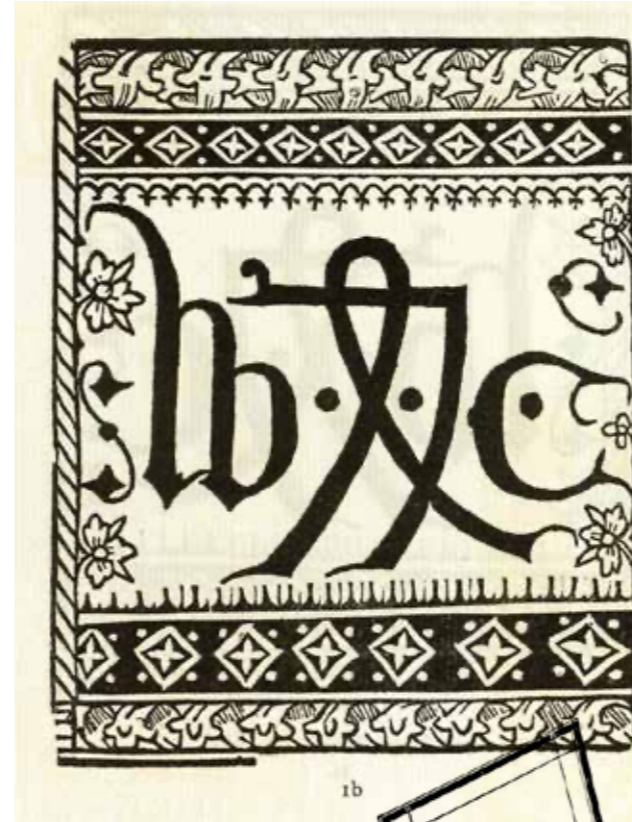

TRANSFORMING THE PRESS

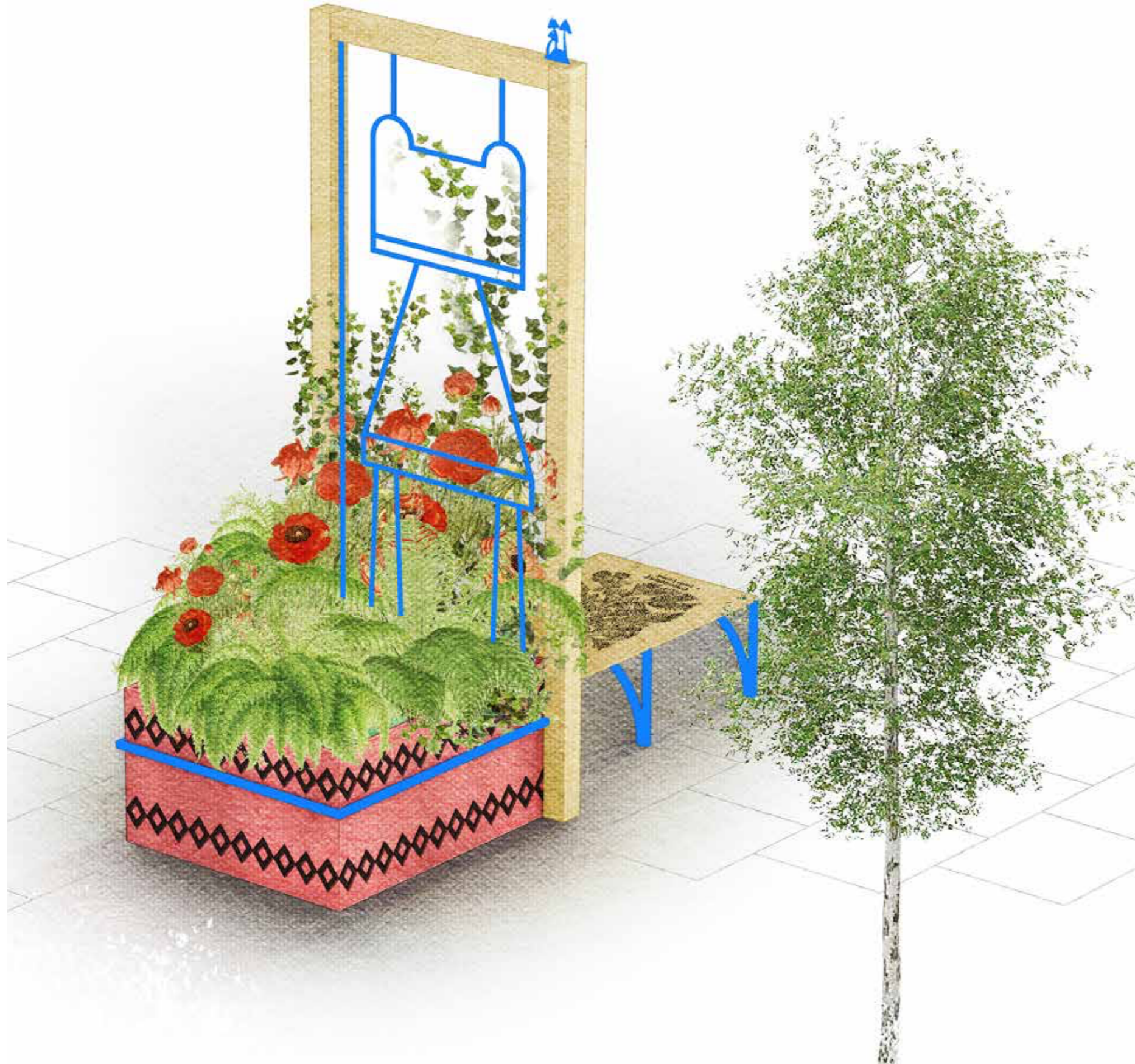

The design takes inspiration from the 15th and 16th century printing presses, the first in the UK, that found their home in Holborn, Fleet St and around the Old Bailey. Each planter is placed within frames whose forms and manner align themselves with the printing presses. In the same way that the presses were double sided, allowing the paper to roll back and forth to make the print, each of these planters has a second side (a bench / seat) which it appears the plants have been printed on to. Each of the prints is taken from Gerards Herbal.

Key points:

- Each will be made as a kit of parts to make sure they can be quickly moved. Any heavy items can be lifted with a pallet truck.
- Both planters and seating will be design at different heights to allow different users (age, height, disability) access - this will be based on previous information supplied for the Mobile Arboretum.
- Trellis / metal frames will all be embedded into the planters with horizontal structure well spaced and made of a thin metal to discourage climbing (based on previous work for Moor Lane and Mobile Arboretum in the Col.).



THE FINE PRINT - design details



Early woodblock details from Wynkyn De Wordes work comes to life and start to appear across the structures



Forms taken from images of the first printing presses give shape in the project, becoming trellises or a place to espalier a tree on.



Early woodblock details from Wynkyn De Wordes work also forms a woodblock print that runs around the planters to give detail and amplify the connection to their medieval inspiration.

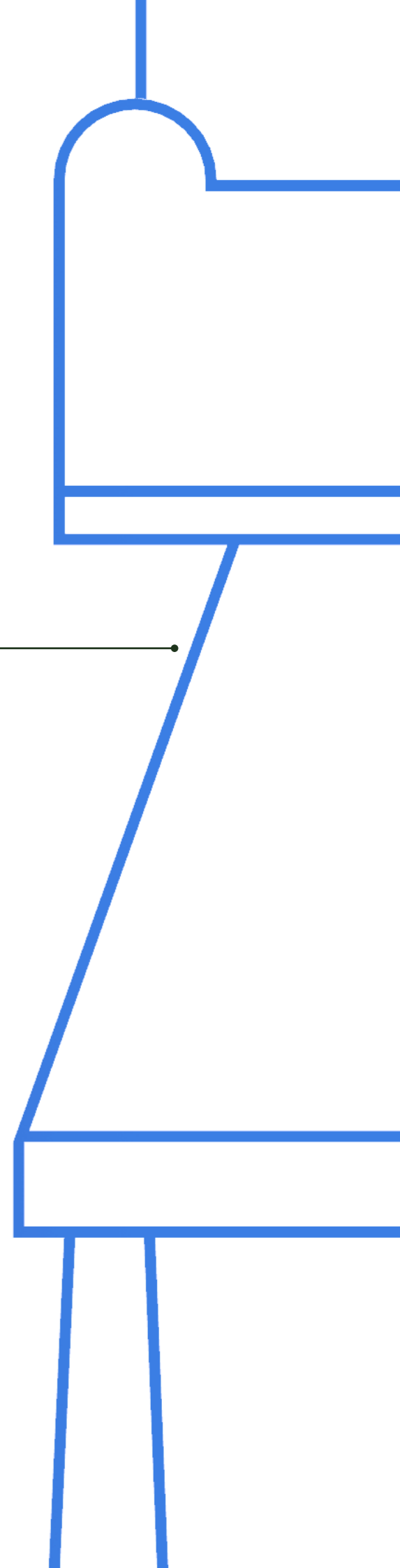

CATALOGUS OF PARTS



SITE PLAN - proposed at Holborn Circus



The proposed layout is based on the following points:

- A clear 1.2m, distance from the edge of the pavement to allow access and clear viability next to the road.
- Careful placement alongside existing seating so they feel integrated and as if they support the existing infrastructure
- The layout has room to be tweaked on site in relation to service hatches.
- A potential addition 2 on the north side will act as a sign post allowing pedestrians to see it from all routes clearly.



THE FLEET STREET CATALOGUS

As a part of the project we want to create a small zine that mirrors Gerards original Catalogus. The new Plant Press Catalogus will contain all the plants in the new garden supported by the prints of John Gerard to tie it to it's history.

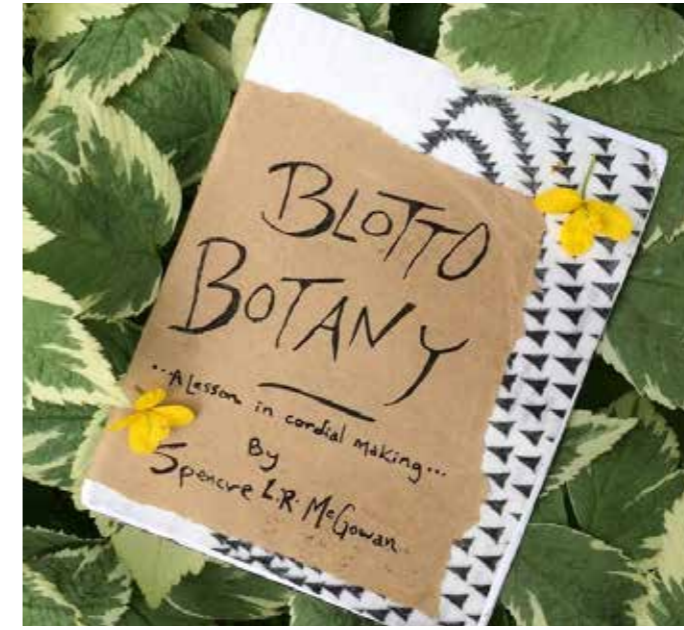
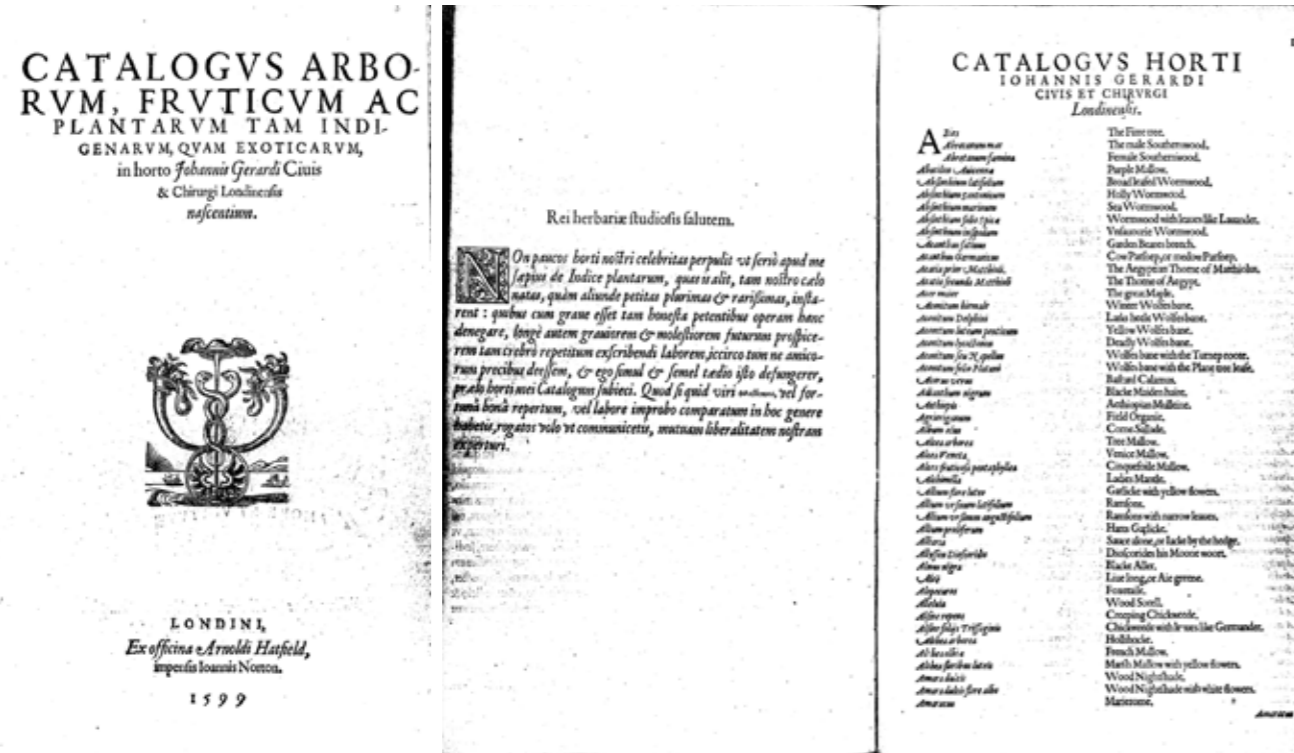

PLANT CATALOGUS

The planting takes itself from the original garden of John Gerard and his Catalogus of Plantes. The initial focus has been on evergreen, scented and medicinal plants.

There are more to be added to the plan including some small fruiting trees such as apple and pear.

The final plant list with aim to both compliment the story of the plants coming from Gerards original garden in Holborn as well as creating a year round and low maintenance plant pallet.



Artemesia (southernwood)



Yarrow



Ladies Mantle



Bugle



Comfrey



Great Burnet



Spurge



Solomons Seal



Self Heal

PLANT CATALOGUS



Dyers Woodruff



Hyssop



Iris



Cotton Lavender



Lavender



Lemon Balm



Meadowsweet



Oregano



Winter Savory



Sweet woodruff



Soapwort



Rue

THANK YOU